

0577

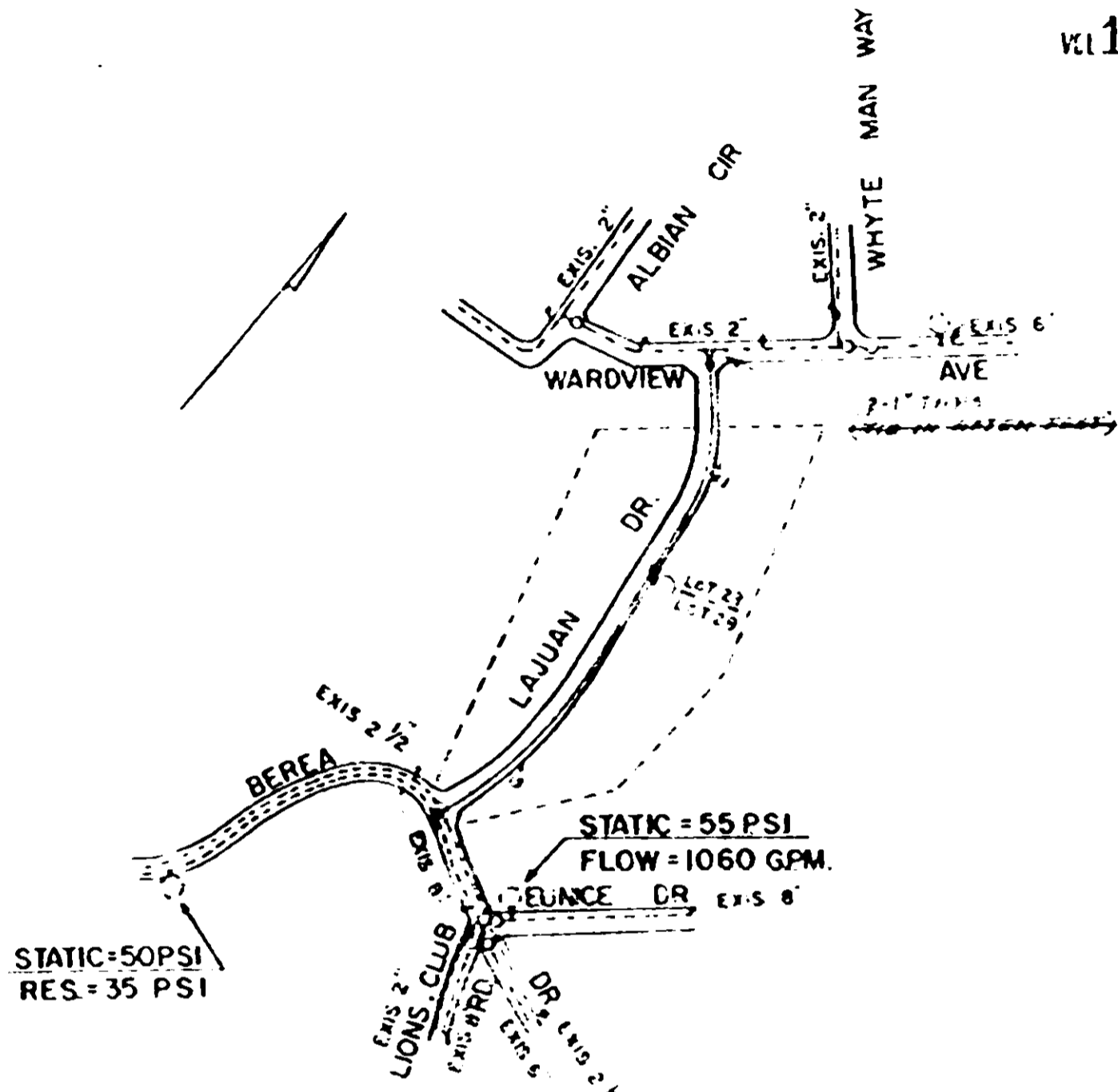

STATIC = 50 PSI
RES. = 35 PSI

STATIC = 55 PSI
FLOW = 1060 GPM.

NOTE: ALL 6" VALS OPEN RT
ALL 2" VALS OPEN LT
ALL HYDS TO BE 3 WAY
8 OPEN RT

STRATFORD SEC. II

SCALE 1" = 400' OCT 1, 1975

MATERIAL LIST
[Faint, illegible text]

RECORDED AUG 3 1973
at 11:43 A.M.

3656

4328 W-23